









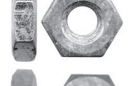

Hex Head Machine Nuts

Description	Zinc or Blk.		Zinc Grade 5		Zinc Grade 8		Stainless Steel	
	Number	Price	Number	Price	Number	Price	Number	Price
 6-32	FA 2671 D	\$0.25	FA 2671 B	\$0.25	---	---		FA 966 H \$0.30
 8-32	FA 967 B	\$0.30	FA 967 A5	\$0.25	----	----		FA 967 H \$0.30
 10-24	FA 3059 A	\$0.30	FA 4908 B	\$0.35	----	----		FA 968 H \$0.30
 10-32	FA 2672 A	\$0.30	---	---	----	----		FA 969 H \$0.35
 1/4-20	FA 4716 B	\$0.35	FA 3380 A	\$0.30	----	----		FA 970 H \$0.45
5/16-18	FA 4911 B	\$0.45						

Hex Head Nuts

 1/4-20	FA 2165 A2	\$0.25	FA 2165 A5	\$0.30	FA 2165 AY8	\$0.35		FA 961 H \$0.45
1/4-28	FA 2166 A2	\$0.25	FA 2166 A5	\$0.30	FA 2166 AY8	\$0.35	---	---
 5/16-18	FA 2167 A2	\$0.35	FA 2167 A5	\$0.40	FA 2167 AY8	\$0.45		FA 962 H \$0.55
5/16-24	FA 2168 A2	\$0.35	FA 2168 A5	\$0.40	FA 2168 AY8	\$0.45	---	---
 3/8-16	FA 2169 A2	\$0.50	FA 2169 A5	\$0.40	FA 2169 AY8	\$0.50		FA 963 H \$0.75
3/8-24	FA 2170 A2	\$0.35	FA 2170 A5	\$0.40	FA 2170 AY8	\$0.50	---	---
 7/16-14	FA 2171 A2	\$0.65	FA 2171 A5	\$0.90	FA 2171 AY8	\$0.90		FA 2548 H \$0.85
7/16-14	Double Chamfered							FA 4854 H \$0.95
7/16-20	FA 2172 A2	\$0.50	FA 2172 A5	\$0.55	FA 2172 AY8	\$0.65		FA 2172 B8 \$0.65
 1/2-13	FA 2173 A2	\$0.55	FA 2173 A5	\$0.70	FA 2173 AY8	\$0.80		FA 964 H \$1.30
1/2-13	Heavy Hex		---	---	---	---		FA 4613 H \$1.95
 9/16-12	FA 2174 A2	\$0.60	FA 2174 A5	\$0.75	FA 2174 AY8	\$0.85		
9/16-18	FA3423 A	\$0.85	Heavy Nut	----	----	----		
5/8-11	Double Chamfered		---	---	---	---		FA 965 H \$1.95
 5MM-80 Black	FA 3129 B	\$0.35						
8MM-1.25 Black	FA 3130 B	\$0.45						

Nylon Insert Lock Nuts



Number	Price	Description
FA 952 H	\$0.35	6-32 Nylon Insert Lock Nut, S.S.
FA 953 H	\$0.40	8-32 Nylon Insert Lock Nut, S.S.



FA 954 H	\$0.45	10-24 Nylon Insert Lock Nut, S.S.
FA 955 H	\$0.45	10-32 Nylon Insert Lock Nut, S.S.

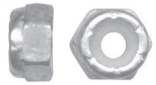

FA 956 H	\$0.65	1/4-20 Nylon Insert Lock Nut, S.S.
----------	--------	------------------------------------

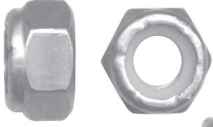

FA 957 H	\$0.75	5/16-18 Nylon Insert Lock Nut, S.S.
----------	--------	-------------------------------------

FA 4737 AY	\$0.65	5/16-24 Nylon insert Lock Nut, Yellow Zinc
------------	--------	--



FA 958 H	\$0.90	3/8-16 Nylon Insert Lock Nut, S.S.
----------	--------	------------------------------------

FA 4892 A	\$1.60	3/8-24 Nylon Insert High Lock Nut, Zinc
-----------	--------	---

FA 959 H	\$2.40	1/2-13 Nylon Insert Lock Nut, S.S.
----------	--------	------------------------------------

FA 960 H	\$3.85	5/8-11 Nylon Insert Lock Nut, S.S.
----------	--------	------------------------------------

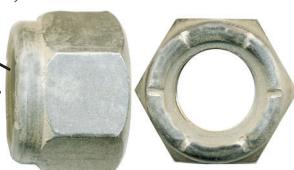

Square Head Nuts

FA 3049 A	\$0.15	8-32 Square Nut Zinc
-----------	--------	----------------------

FA 3379 A	\$0.20	10-24 Square Nut, Zinc
-----------	--------	------------------------

FA 3050 A	\$0.25	12-24 Square Nut Zinc
-----------	--------	-----------------------

FA 3444 A	\$0.30	1/4-20 Square Nut, Zinc
-----------	--------	-------------------------

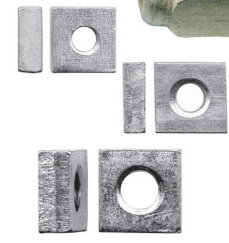

Hex Head Jam Nuts

FA 4749 A	\$0.35	5/16-18, Zinc	FA 4749 H	\$0.60	18-8, S.S.
-----------	--------	---------------	-----------	--------	------------

FA 4750 H	\$0.65	5/16-24 Hex Jam Nut 18-8, S.S.
-----------	--------	--------------------------------

FA 3063 A	\$0.45	3/8-16, Zinc	FA 3063 H	\$0.60	18-8, S.S.
-----------	--------	--------------	-----------	--------	------------

FA 4751 H	\$0.95	1/2-13 Hex Jam Nut, 18-8 S.S.
-----------	--------	-------------------------------

FA 4738 D	\$0.80	1/2-20 Hex Jam Nut, Dic
-----------	--------	-------------------------



Reversible Lock Nuts.

FA 3328 A	\$0.40	1/4-20 Hex Reversible Lock Nut, Zinc
-----------	--------	--------------------------------------

FA 3954 A	\$0.45	1/4-28 Hex Reversible Lock Nut, Zinc
-----------	--------	--------------------------------------

FA 3329 A	\$0.60	5/16-18 Hex Reversible Lock Nut, Zinc
-----------	--------	---------------------------------------

FA 3955 A	\$0.55	5/16-24 Hex Reversible Lock Nut, Zinc
-----------	--------	---------------------------------------

FA 3330 A	\$0.85	3/8-16 Hex Reversible Lock Nut, Zinc
-----------	--------	--------------------------------------

FA 3956 A	\$0.90	3/8-24 Hex Reversible Lock Nut, Zinc
-----------	--------	--------------------------------------

FA 3331 A	\$0.90	7/16-14 Hex Reversible Lock Nut, Zinc
-----------	--------	---------------------------------------

FA 4147 A	\$0.95	7/16-20 Hex Reversible Lock Nut, Zinc
-----------	--------	---------------------------------------

FA 3336 A	\$1.00	1/2-13 Hex Reversible Lock Nut, Zinc
-----------	--------	--------------------------------------

FA 4148 A	\$1.05	1/2-20 Hex Reversible Lock Nut, Zinc
-----------	--------	--------------------------------------



Prevailing Torque Lock Nuts



FA 1954 K \$0.50
1/4-20 Lock Nut
Grade 8, Cad.



FA 1955 K \$0.50
1/4-28 Lock Nut
Grade 8, Cad.

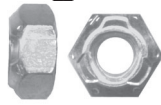

FA 1956 K \$0.60
5/16-16 Lock Nut
Grade 8, Cad.



FA 1957 K \$0.60
5/16-24 Lock Nut
Grade 8, Cad.

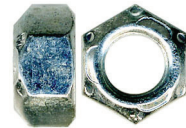

FA 1958 K \$0.90
3/8-16 Lock Nut
Grade 8, Cad.

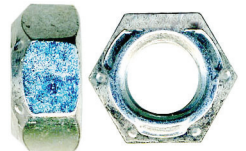

FA 1959 K \$0.90
7/16-14 Lock Nut
Grade 8, Cad.



FA 1882 A \$0.25
6-32 HWH Nut w/
Serrated Flange, Zinc

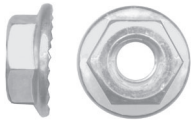

FA 1886 A \$0.35
1/4-20 HWH Nut
w/19/32 Ser. F., Zinc
FA 1886 H \$0.50
14-20 Serrated Hex
Flange Nut, 18-8 S.S.



FA 4872 AY8 \$0.60
14-20 Serrated Hex
Flange Nut, G8, Y Zinc



FA 4845 A \$0.60
3/8-16 HWH Nut
w/15/16 Serrated
Flange, Zinc



FA 1898 B \$0.75
5MM-0.80 HWH Nut
w/13MM F., Black



FA 4919 B \$0.60
6MM-1.0 HWH Nut
w/17MM F., Zinc



FA 1883 A \$0.30
8-32 HWH Nut
w/Ser. 15/32 F., Zinc
FA 1883 H \$0.35
8-32 Serrated Hex
Flange Nut, 18-8 S.S.



FA 4843 A \$0.45
1/4-20 HWH Nut
w/11/16 Serrated
Flange, Zinc

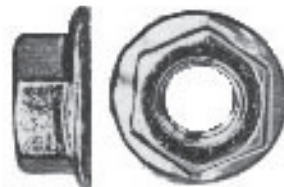

FA 1892 A \$0.60
7/16-14 Serrated Nut
w/15/16 Flange, Zinc

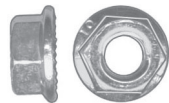

FA 3599 A \$0.55
6MM-1.0 HWH Nut
w/13MM F., Zinc

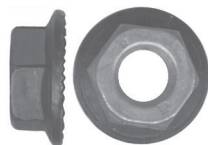

FA 1899 B \$0.75
8MM-1.25 HWH Nut
w/16MM F., Black

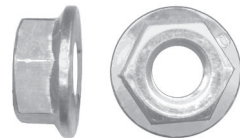

FA 1896 A \$0.60
8MM-1.25 HWH Nut
w/16MM F., Zinc

Hex Washer Head Nuts

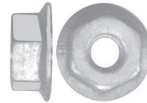

FA 1884 A \$0.45
10-24 HWH Nut
w/Ser. 1/2 F., Zinc
FA 1884 H \$0.45
10-24 Serrated Hex
Flange Nut, 18-8 S.S.



FA 1888 A \$0.55
5/16-18 HWH Nut
w/11/16 F., Zinc
FA 1888 H \$0.55
5/16-18 Serrated Hex
Flange Nut, 18-8 S.S.

FA 1889 A \$0.45
5/16-24 HWH Nut
w/11/16 Ser Flange, Zinc

FA 1891 A \$0.55
3/8-24 HWH Nut
w/3/4 F., Zinc

FA 1893 A \$0.60
7/16-20 Serrated
Flange Nut
w/15/16, Zinc

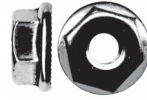

FA 2603 A \$0.40
10-24 HWH Nut 1/2
Smooth F., Zinc - Disc.

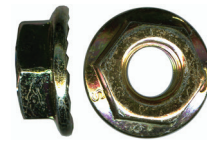

FA 4873 AY8 \$0.70
5/16-18 Serrated Hex
Flange Nut G8, Y Zinc



FA 4844 A \$0.55
5/16-18 HWH Nut
w/13/16 Serrated
Flange, Zinc

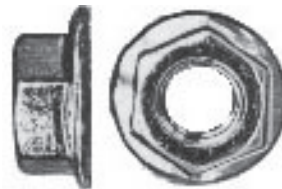

FA 1894 A \$0.70
1/2-13 HWH Nut,
Serrated Flange, Zinc

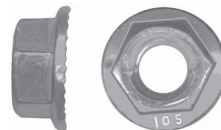

FA 4044 A \$0.65
M8-1.25 HWH Nut
17MM O.D. 12MM Head
- Discontinued



FA 1885 A \$0.40
10-32 HWH Nut
w/1/2 Ser. F., Zinc
FA 1885 H \$0.45
10-32 Serrated Hex
Flange Nut, 18-8 S.S.



FA 1890 A \$0.45
3/8-16 HWH Nut
w/3/4 Ser. F., Zinc
FA 1890 H \$0.65
3/8-16 Serrated Hex
Flange Nut, 18-8 S.S.



FA 4874 AY8 \$0.75
3/8-16 Serrated Hex
Flange Nut G8, Y Zinc

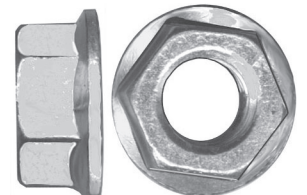

FA 1895 A \$0.80
1/2-20 HWH Nut. Ser-
rated, Flange, Zinc



FA 1897 B \$0.65
10MM-1.50 HWH Nut
w/20MM F., Black

Hex Washer Head Nuts



*All fastener pictures will print out Actual Size in the catalog

FA 4689 B \$0.35
6-32 Lock Nut Serrated,
Flange, Blk.



FA 1864 B \$0.35
8-32 w/15/32
Serrated F., Blk.



FA 1865 B \$0.35
10-24 w/1/2
Serrated F., Blk.



FA 1866 B \$0.40
10-32 w/1/2
Serrated F., Blk.



FA 4690 B \$0.50
12-24 Lock Nut
Serrated F., Blk.



C6028800 \$0.40
1/4-20 Lock Nut
w/9/16 Flange, Blk.
- Discontinued



FA 1867 B \$0.40
1/4-20 w/19/32
Serrated Flange, Blk.



FA 1868 B \$0.55
1/4-20 w/11/16
Serrated F., Blk.



FA 1869 B \$0.40
1/4-28 w/19/32
Serrated F., Blk.



FA 1870 B \$0.55
5/16-18 HWH Nut
w/11/16 Ser. F., Blk.



FA 1871 B \$0.60
5/16-18 w/13/16 F.
Serrated, Blk.



FA 1872 B \$0.50
5/16-24 w/11/16 F.
Serrated, Blk.



FA 4239 B \$0.45
3/8-16 HWH Nut
w/11/16 Smooth
bottom F., Blk.



FA 1874 B \$0.50
3/8-16 HWH Nut
w/3/4 Ser. F., Blk



FA 4431 B8 \$0.75
3/8-16 HWH Nut
w/13/16 Smooth
bottom F.G8, Black



FA 1875 B \$0.65
3/8-16 HWH Nut
w/7/8 Serrated F., Blk



FA 1876 B \$0.60
3/8-24 HWH Nut
w/3/4 Serrated F., Blk



FA 1878 B \$0.85
7/16-14 Nut
w/15/16 Serrated
Flange, Black



FA 1879 B \$0.85
7/16-20 Nut
w/15/16 Ser. F., Blk.



FA 1880 B \$0.85
1/2-13 Nut w/1"
Serrated Flange, Blk.



FA 4432 B8 \$1.25
1/2-13 HWH Nut
w/1-1/32" F.G8, Black

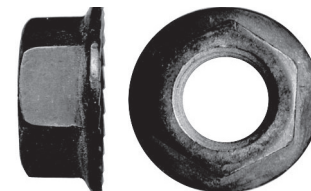

FA 1881 B \$1.00
1/2-20 Nut
w/1-1/32 Serrated
Flange. Black

All items marked discontinued will be available until we run out and remove from the catalog. No discount on them.

Hex Head Nuts w/Loose Washers



FA 1900 A \$0.45
8-32 H/L (11/32 H.)
w/ 3/8" W., Zinc



FA 4851 A \$0.45
10-24 H/L (3/8 H.)
w/7/16" W., Zinc



FA 3995 AY \$0.75
10-24 H/L Nut w/
3/4" W, Yellow Zinc.
replaces 6023203



FA 3995 B \$0.75
10-24 H/L Nut w/
3/4" W, Black



FA 3998 A \$0.40
10-32 H/L Nut
w/ 3/8" W., Zinc



FA 4852 A \$0.45
10-32 H/L (3/8 H.)
w/7/16" W., Zinc



FA 4849 A \$0.45
1/4-20 H/L (7/16 H.)
w/ 1/2" W., Zinc



FA 1907 A \$0.65
1/4-20 H/L (7/16 H.)
w/ 5/8" W., Y Zinc

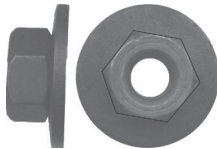

FA 1909 B \$0.79
1/4-20 H/L (7/16 H.)
w/ 3/4" W., Blk.

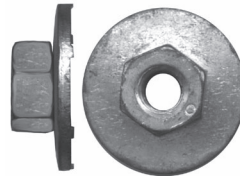

FA 4607 A \$0.85
1/4-20 H/L Nut w/7/8
Toothed W., Zinc
* Repro was C 6029694



FA 1910 B \$0.70
1/4-20 H/L (7/16 H.)
w/ 1" Toothed W.,
Parkerized



FA 4893 K \$0.90
5/16-18 H/L (1/2 H.) w/ Stamped
Concaved 1" W., Yellow Cadmium



FA 1913 B \$0.75
5/16-18 H/L (1/2 H.)
w/ 3/4" W., Blk. replaces
C6025177

All items marked discontinued will be available until we run out and remove from the catalog. No discount on them.

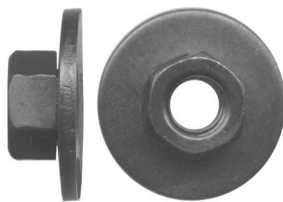

FA 2427 B5 \$1.05
5/16-18 H/L (1/2 H.)
w/1" W., Blk



FA 3449 B \$0.85 - Discontinued
5/16-18 H/L w/1-1/4 "W., Blk



FA 1915 B \$0.85
3/8-16 H/L (9/16 H.)
w/ 7/8" W., Blk.

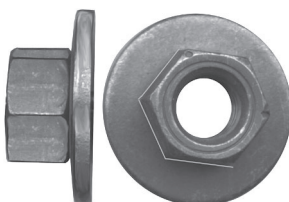

FA 3574 D \$0.95
3/8-16 H/L Nut w/ 1" Washer, Dic.

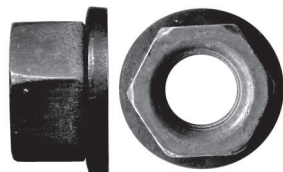

FA 3575 B \$0.95
7/16-14 H/L Nut
w/7/8 w/W., Blk.

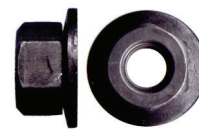

FA 1920 B \$0.60
6.3MM H/L / 16MM W.,
Blk.

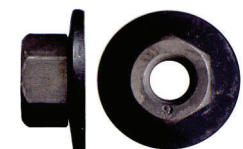

FA 1921B \$0.60
6.3MM H/L w/ 19MM
W., Blk.